

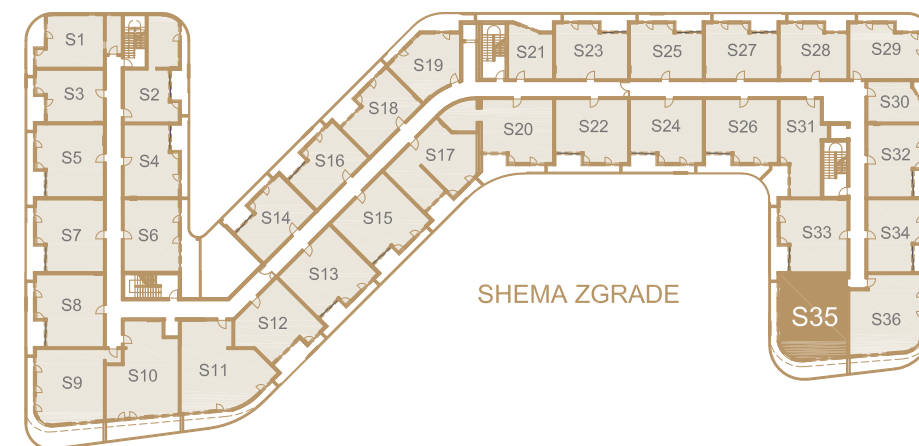

### STAN S35

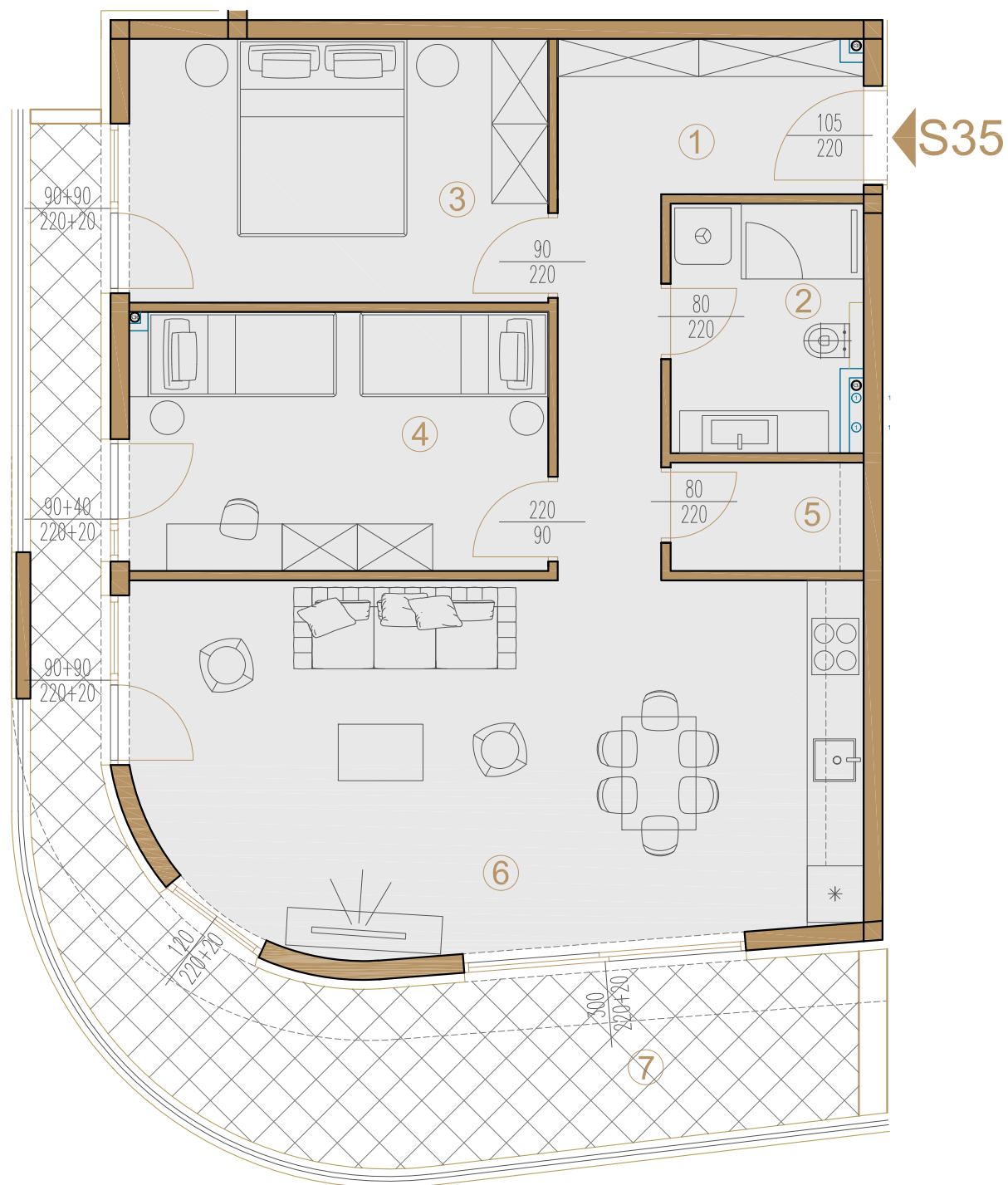

### ISKAZ NETO POVRŠINA

STAN S35				
br.	naziv prostorije	netto m <sup>2</sup>	koef.	netto x koef. m <sup>2</sup>
1	hodnik + garderoba	9,78	1	9.78
2	kupaonica	5,26	1	5.26
3	spavaća soba	12,46	1	12.46
4	spavaća soba	12,20	1	12.20
5	spremište	2,36	1	2.36
6	kuhinja+db+blag.	29,16	1	29.16
S35 zatvoreno neto:		71.22		71.22
7	dio nenatkrivena terasa	11,26	0,25	2.82
	dio lođa	10,87	0,75	8.15
S35 sveukupno neto:		93.35		82.19

